

This is not a certified copy

# PALM BEACH PARK

BEING A SUBDIVISION OF THE N ½ OF SEC 26 T43 S R37 E

PALM BEACH COUNTY, FLA.

BRIDGEMAN AND ALLEN, INC.  
ENGINEERS  
307 GARDENIA ST.  
WEST PALM BEACH, FLA.

30  
26  
April  
1929  
C. B. Stone

# 79

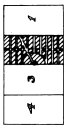

KEY MAP

MARCH 1926 SCALE 1/4" = 100 FT.

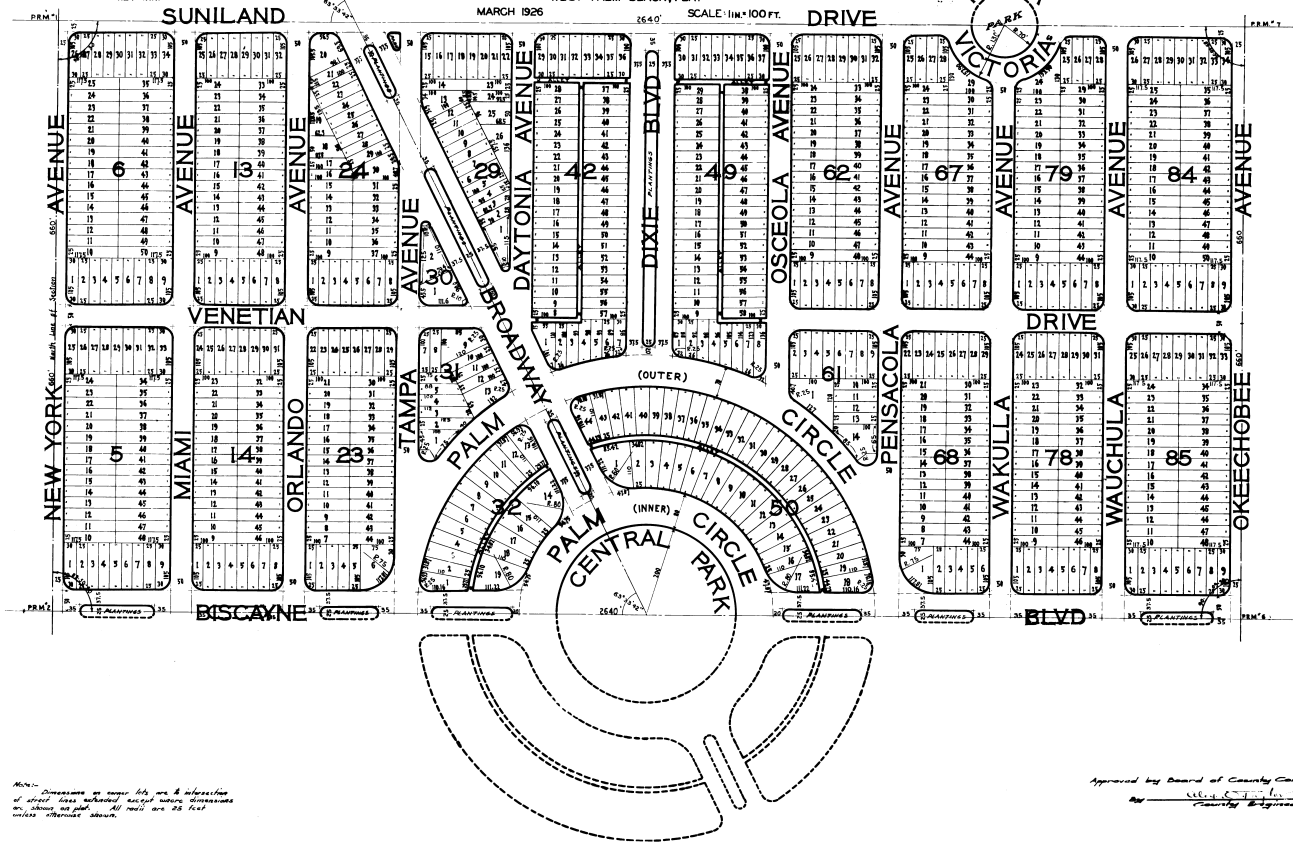

NOTE - Dimensions on maps are for use & reference of record. They are not intended to be used as a basis for any other purpose. All maps are 25 feet wide unless otherwise shown.

Approved by Board of County Commissioners  
C. B. Stone  
County Engineer